



Dolphin Yachts

INTERNATIONAL YACHT BROKERS

Dolphin Yachts S.L.

Club de Mar

07015 Palma de Mallorca

Spain

info@dolphin-yachts.com



Grand Soleil 50

Builder:	Grand Soleil	LOA:	14.92m (49'0")
Model:	50	Beam:	4.56m (15'0")
Year:	2006	Draft:	2.55m (8'4")
Construction:	GRP	Fuel:	290 Litres
Accommodation:	6 berths in 3 cabins	Water:	460 Litres
Designer:	Judel & Vrolijk	Engines:	1 x 75hp Volvo Penta
Displacement:	13500 kg	Keel:	Lead

250.000 € EU VAT paid



ENGINE:

1 x 75hp Volvo Penta D2

CAPACITIES:

Fuel: 290 Litres

Water: 460 Litres

MECHANICAL EQUIPMENT:

Air conditioning preinstallation (2024)

Fisher Panda 5000i generator (2024)

60 Ah battery plus a dedicated charger (2024)

6 AGM100 Ah battery plus 75A mastervolt charger (2024)

Solar panels 480w on bimini 480 w (2024)

Spectra watermaker

Maxprop 4 blade

NAVIGATION:

All Raymarine electronics (2009)

Icom VHF

DECK:

Antifouling done 2024

Bimini cloth replaced (2024)

Dodger

Electric anchor winch

SPARS & SAILS:

Set of sails

2 Harken 60 electric winches

SAFETY:

Epirb

8-person liferaft

TENDERS/TOYS:

Rib plus 5hp Mercury outboard

BROKERS COMMENTS:

This Grand Soleil 50 for sale was designed by Judel & Vrolijk and built by Cantieri del Pardo. The result is a good performance easy to handle short handedly yacht which is in private use and has been well prepared for serious cruising. CE Category A

LYING:

Mallorca

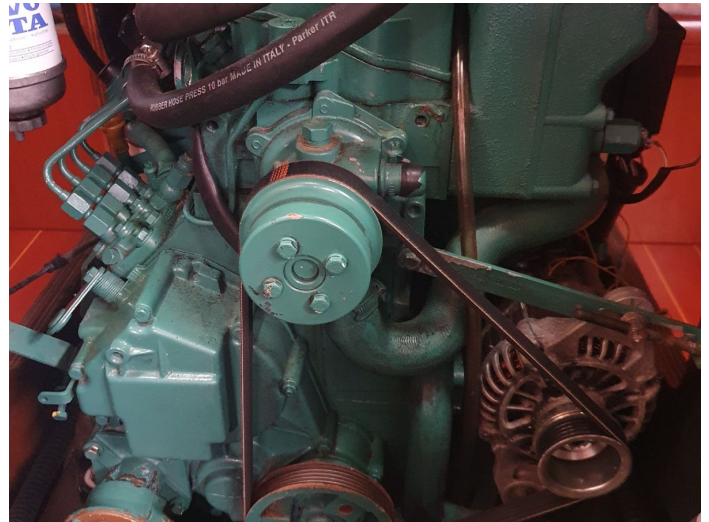



Layout Plans

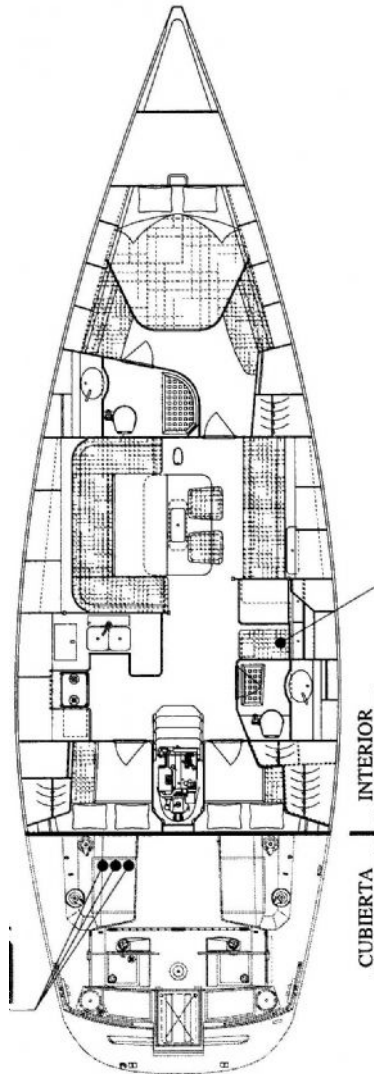

The particulars presented in this brochure are based on information provided by the sellers and are believed to be correct, although we cannot be liable for any inaccuracy. A prospective buyer is strongly advised to check these particulars and where appropriate and at his own expense to employ a qualified marine surveyor and / or have an engine trial conducted which if conducted by us shall not imply any liability on our part.