



Dolphin Yachts

INTERNATIONAL YACHT BROKERS

Dolphin Yachts S.L.

Club de Mar

07015 Palma de Mallorca

Spain

info@dolphin-yachts.com



Jongert 2700M

Builder:	Jongert	LOA:	27.00m (88'6")
Model:	2700M	Beam:	6.55m (21'5")
Year:	2001	Draft:	3.20m (10'5")
Construction:	Aluminium	Fuel:	3.900 Litres
Accommodation:	6 berths in 3 cabins	Water:	3.000 Litres
Designer:	Doug Peterson	Engines:	1 x 257hp Scania
Displacement:	75000 kg	Keel:	Large Fin

1.750.000 € EU VAT not paid



ENGINE:

1 x 257hp Scania D993
Engine Hours: 20400 aprox.

SPEED:

11 knots aprox.

CAPACITIES:

Fuel: 3900 Litres
Water: 3000 Litres
Holding: 500l

MECHANICAL EQUIPMENT:

Main Generator:

Kohler 35KW, (2016 & documented regular service) installed in the engine room. Approx. hours 6100.

Second Gen Set:

Cummins Onan 22.5kW (2019) installed in the lazarette.

As part of the installation at the time, also fitted were new start batteries, new cabling, new charger and a remote start panel.

Shore Power:

3 phase 380v system with cable, plug.

Plumbing Systems:

Fresh Water & Water Heating System:

Hot water circulation pump (2019)

Fresh water pump (2019)

120 litre s/s domestic hot water boiler immersion tank, (2020)

Watermaker:

HEM 25 Series watermaker.

Approx. 1400 gallons per day (1400 gpd = approx. 220 litres per hour assuming US gallons).

Bilge Pumps:

There are three main bilge pumps which all work through the same manifold to different sections of the bilges: forepeak, foreship fore, foreship aft, engine room, aft ship, and aft peak.

There is a 380-volt AC, a 24-volt DC and an engine driven pump.

They can all run separately or together and can be used to pump the bilge or as fire pumps.

There is no automatic system, but each bilge section has a level sensor alarm.

Tankage:

Fuel:

2 x Fuel Tanks, with total capacity of approx. 3900 litres. The tanks are situated outboard at the engine room.

Fresh Water:

2 x Fresh Water Tanks with total capacity of approx. 3000 litres. The tanks are located under the guest cabin beds.

Aquafine ultraviolet water treatment unit series SL-10A.

Grey/Blackwater holding tanks:

1 x Holding Tank with capacity of approx. 500 litres. The tank is under the floor at the crew mess.

Hamman sewage treatment plant – complete revision and pumps serviced 2019.



Propulsion & Steering:

- MaxProp feathering propeller.
- Shaft fitted with electric shaft brake.
- Steering is Whitlock Mamba gearbox and shaft with an electric auto drive motor.
- Pilothouse helm station.
- Aft helm station.
- Electric oil change System with 150 litres new oil tank and 150 litres tank for dirty oil.

Bowthruster and Stern thruster:

- Hydromar hydraulic bow and stern thrusters, powered via a PTO on the main engine.
- The power take off (PTO) on the main engine will drive the hydraulics, primarily both the thrusters, but the PTO runs the complete system when the engine is running. When sailing the power pack will run everything, except the thrusters.
- Three Hydromar hydraulic power pack pumps.

Electrical Systems:

- Entire electrical system revised 2019 and new LED lighting with dimmers, plus new universal sockets with USB connectors installed.
- New helm switch panels made and new switchgear.

Voltage Systems:

- VIVID has 12v, 24v, 220v and 380v systems.

Battery Banks:

- Engine start batteries(2020).
- Start batteries for Kohler gen set(2020).
- Start batteries for the Cummins gen set (2019)

Battery Chargers:

- 1 x Mastervolt Sine inverter 24v / 2500W.
- 1 x Mastervolt Sine wave inverter 24v / 5000W.
- 3 x Mastervolt 24v / 100A battery chargers – service.
- 1 x Mastervolt 75A battery charger – for main engine.
- 1 x Mastervolt 25A battery charger – for main gen set.
- 1 x Mastervolt 10A battery charger – for the second gen set (unit in lazarette).

ACCOMMODATION:

Berths: 6

Cabins: 3

Head: 3

Crew Berths: 3

Crew Cabins: 2

Owner's Cabin:

- Luxuriously fitted out with a double berth on the centreline.
- There is a desk to starboard and a sofa to port.
- There is generous stowage with shelves, 2 x lockers to starboard, 2 x hanging lockers forward to starboard and drawers under the bed.
- The cabin is light and airy, courtesy of, two deck hatches (and a central emergency exit hatch), and two hull ports each side.
- Large ensuite head / shower area forward to port, with hull port

Port & Starboard Twin Cabins:

- Mirror image twin cabins each side, each with 2 hull ports and a deck prism for light and ventilation.
- Soft furnishing including the bed surrounds were replaced under the current ownership.
- Drawers under the beds. Shelves. Hanging locker. Bedside unit between the beds.



- Each with ensuite head and shower area, which also have a hull port for ventilation and light.

Forward Crew Sleeping Quarters:

- To starboard is a double cabin with raised double berth and stowage under.
- Single berth cabin forward and to port.
- Crew heads aft of single cabin to port.

Crew Area & Galley:

- Dinette to port.
- Washer/dryer installed under the seating to port.
- Galley to starboard with a super U-shaped central work top (with locker and dishwasher below).
- Twin s/s sinks.
- Cooker/hob/oven plus further worktop space outboard.
- 4 x fridge/freezer units are located at the forward end.
- Hull port on port side and large hatch over galley.
- From the dinette area there are steps up through a hatch to the deck.
- A sliding door aft to the saloon

ACCOMMODATION EQUIPMENT:

Sonos Fusion system fitted throughout above and below deck in 2019.

TV screen, DVD player and Apple TV fitted in the saloon also 2019.

Sony Bravia TV

Apple TV system

Sony DVD

AM/FM radio

Pep wave router, 2020 giving good wi-fi throughout.

LED lighting dimmers fitted throughout 2019

Heating & Ventilation:

Complete new Dometic heating and cooling water loop modular system fitted in 2020 including new raw water and coolant pumps.

Air handlers fitted in galley and stewardess cabin, in 2020.

Climma 18kw heating boiler fitted in 2020.

Air handler fitted in captain's cabin in 2019.

At the same time - new aft ship ventilation fan fitted, and the whole system inspected throughout boat with much of the ventilation ducting replaced.

Air-Conditioning:

Dometic modular system fitted in 2020.

Air handlers fitted in the galley and stewardess cabin in 2020.

Air handlers were fitted earlier in 2019 to captain's cabin and the system revised with much new ducting.

The saloon air handlers were fitted with new fans and serviced.

Climma 18kw boiler fitted 2020 for the heating system.

5 x WCs – all Tecma electric toilets new 2019 with new control units fitted, running through grey / sludge tank or via the Hamman system.

Vitrifrigo ice maker machine in the saloon (2019).

2019 the interior was re-furbished, including:

Saloon seating areas rebuilt.

All interior and exterior seating renewed and reupholstered.

All guest cabin panelling around the bed was renewed.

Aft cabin also refitted with panels aft of the bed remade to incorporate pictures and sofa reupholstered.

New Neptune mattresses throughout.

New carpeting.

Crew covers for the floor, tables, chairs, and upholstery.

Much of the pilothouse was revarnished.

Leather covered handrails at companionway and in the aft passage and at the forward part of the saloon.

Custom marquetry work decor panels in the main saloon by ARYMA



Specially commissioned artwork in the main cabin by well-known French artist Georges Cabot, known as Geca

GALLEY/LAUNDRY:

Miele induction 3-burner hob and Miele oven – gimballed for use at sea.

Bosch Series 8 Dishwasher– (2016), which can operate via the inverter.

Miele Clothes Washer (2022)

Clothes Dryer Miele – (2016), serviced 2022.

Miele microwave and convection oven, which can operate via the inverter.

24v refrigeration and freezers by Frigomar – the system was new in 2012, with 4 x 200 litre refrigeration / freezer interchangeable units.

Extractor hood with light over the cooker.

Nespresso coffee machine.

NAVIGATION:

A substantial upgrade and renewal program on her navigation and communication equipment was done in 2019 in Palma the following were installed:

- New Furuno chart-plotters (3) fitted to helm station, pilothouse and captain's cabin.
- All B&G graphic display units swapped for series 5000.
- New B&G computer fitted.
- New B&G autopilot system and control, plus a handheld Bluetooth remote unit.
- New Icom VHF radio fitted in pilothouse with additional station aft.
- New 4G/Wi-Fi Pep wave router fitted.
- New computer and screen fitted in pilothouse.
- There are B&G repeater units also at the crew mess and the captain cabin.

In March 2021 in the UK:

- New 4G and Wi-Fi antennas fitted to mast with new coaxial cable.
- New VHF antenna fitted to mast with new coaxial cable.

Other Navigation Instruments on Board:

- Furuno Radar 2807.
- Furuno chart plotter.
- 1 x Furuno GPS, GP170.
- Furuno heading sensor.
- 6 x B&G 5000 series displays
- B&G gyro compass.

Communications:

- Thrane and Thrane Sailor Fleet Broadband 500 satellite voice and data.
- Thrane and Thrane Sat C Capsat - Tracking, EGC.
- Icom IC-M506 VHF (2018-9) with a "Command Mic" plug in unit for the helm.
- Intellian VSat 60cm satellite voice and data.
- Iridium handheld sat phone.
- 2 x Icom handheld VHF's.

DECK:

- Aft hydraulic swim platform door.
- Aft hydraulic boarding passarelle.
- Hydraulic operated up / down aft side windows to the deckhouse
- Side boarding ladder (one, which may be installed either side).
- Extensive tool kit.
- Stainless drink holders by each helm.

Anchoring & Mooring Equipment:

- Hydromar hydraulic anchor windlass mounted at bow with a plug-in handheld unit and a control at the helm.
- Bruce 80kg galvanized plough anchor.



- 140m of galvanized chain.

Covers, Canvas & Cushions:

- Sunscreen covers for the deckhouse windows.
- Crew covers for cockpit seating, the cockpit table, wheels, pedestals and winches.
- White removable panels with windows in for the aft end of the cockpit to enclose it.
- Sun awning that mounts over the aft section of the boom.
- Cover to install in the boom as a sun protection to the mainsail.
- Sunbed cushions and loose sun pillows for the aft sundeck area.

SPARS & SAILS:

Rig:

- Sloop cutter rig.
- Marten Marine carbon fibre mast and boom.
- Mast removed and a complete five-year service by Advanced Rigging, Hamble was made, with all new s/s rod standing rigging in 2020-21.
- In boom mainsail furling.
- Reckmann hydraulic headstay and staysail furlers.
- Both foresail furlers were sent to Reckmann for full service (2021).
- Navtec hydraulic system, for the boom-vang, the double backstays, and inner stay (for staysail).
- Genoa and staysail halyard tensioner.
- The running rigging has been renewed in stages since 2019 (2021).

Sails:

- Mainsail, Staysail and Yankee – new March 2019 (in Spectra by Elvstrom Mallorca).
- Asymmetrical Spinnaker in hoisting sock.

Winches:

- Lewmar winches.
- 2 x 111 hydraulic for genoa sheets.
- 1 x 77 hydraulic for the mainsheet.
- 1 x 77 hydraulic halyard winch.
- 1 x 77 manual halyard winch.
- 2 x 77 manual staysail winches.
- 2 x 66 for the running backstays, manual.
- 2 x 54 traveller winches, manual.
- Captive winch for mainsail halyard, located under the galley floor

SAFETY:

- 2 x Viking 8-man life rafts.
- 2 x JON Buoy Man Overboard modules (2016).
- Extensive world cruising medical equipment, Category 1
- Defibrillator,
- Ditch bag and Ditch med kit
- 1 x Oxygen kits.
- Offshore flare kit.
- Jotron EPIRB.
- 1 x McMurdo Personal EPIRBs.
- AIS (full send and receive).

New Safety Equipment 2019:

- 11 x adult Spinlock lifejackets with AIS locators and 2 x junior Spinlock lifejackets with AIS locators.

New Safety Equipment 2022:

- 6 x Spinlock life vests and lifejackets (in the tender).

Fire-fighting equipment:



- Engine room FM200 fire suppression system.
- 7 x Dry Chem fire extinguishers.
- 2 x CO2 fire extinguisher.
- 1 x Foam fire extinguisher at galley.
- 1 x Fire blanket.

TENDERS/TOYS:

Tender, Outboard & Toys:

- Novurania 400DL, w/ Yamaha 40 hp 4-stroke engine, both (2012).
- Wakeboard.
- Ring donut.
- 2 x Paddleboards.

Toys 2019:

- 15 x sets of Tusa fins assorted sizes
- 8 x adult Tusa masks and snorkels
- 4 x junior Tusa masks and snorkels

SERVICE HISTORY AND CONSTRUCTION:

Hull, Deck & Superstructure Construction:

Hull, deck and superstructure are all of Aluminium.

Teak laid deck on top of the aluminium.

The hull was resprayed by Desty Marine at Endeavour Quay, Gosport (2020).

Keel & Rudder:

Complete new rudder fabricated and fitted with new bearing and seals (by Links Marine of Mallorca, a Lloyds certified fabricator) in 2019.

BROKERS COMMENTS:

Best opportunity on the market to acquire a desirable turnkey ready to go aluminium Jongert 2700M due to her owners change of plans. Doug Peterson for the performance and Peter Sijm on the design, plus Jongert shipyard to deliver the highest quality craftsmanship from Holland.

Ready to go around the world in style and comfort with amazing features: like the open plan pilothouse allowing you to be either fully protected in cold destinations or semi opened in warmer climates with both hot and cold reverse cycle air conditioning; the 4m Rib recessed and integrated on deck allowing more visibility, safety and flush looks; her garage with large hydraulic bathing platform; very comfortable area for 3 crew in 2 cabins.

All together this Jongert 2700 M sailing yacht in the luxury segment is one of the best buys available.

LYING:

Spain





Layout Plans

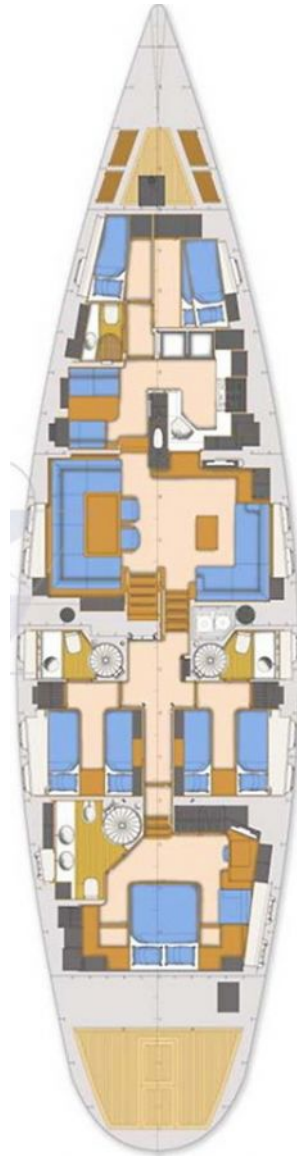

The particulars presented in this brochure are based on information provided by the sellers and are believed to be correct, although we cannot be liable for any inaccuracy. A prospective buyer is strongly advised to check these particulars and where appropriate and at his own expense to employ a qualified marine surveyor and / or have an engine trial conducted which if conducted by us shall not imply any liability on our part.