



Dolphin Yachts

INTERNATIONAL YACHT BROKERS

Dolphin Yachts S.L.

Club de Mar

07015 Palma de Mallorca

Spain

info@dolphin-yachts.com



Fountaine Pajot Aura 51

Производитель:	Fountaine Pajot	Длина:	15.54m (51'0")
Модель:	Aura 51	Ширина:	8.08m (26'5")
Год выпуска:	2022	Осадка:	1.50m (4'9")
Материал:	Стеклопластик	Топливо:	450 Litres
Размещение:	10 berths in 5 cabins	Вода:	900 Litres
Дизайнер:	Berret-Racoupeau	Двигатели:	2 x 75hp Volvo Penta
Водоизмещение:	18100 kg	Киль:	Skeg

1.500.000 US\$ НДС не уплачен



Двигатели:

2 x 75hp Volvo Penta D2-75

Часы наработки: 3200 aprox.

Вместимость:

Топливный бак: 450 Litres

Бак пресной воды: 900 Litres

Механическое оборудование:

GENERATOR

13,5KW 220V 50HZ genset

CONVERTER

Victron 220V Multiplus3000W

Victron 110V 2000W

Watermaker 180L/H 50HZ

Battery charger Victron Multiplus 12V/3000W/120Amp

Victron Multiplus 12V/2000W/80Amp

ENGINE

Access via polyester deck hatch installed on stainless steel gas cylinders

Soundproofing

Holds lit by 1 neon

2 sail-drive Volvo Penta D2-75F (75HP) engines

2 three-blade fixed propellers

Salt water filters

Engine cooled via heat exchanger

Complete engine panel and dual controls at helm station

Hour meter

450L fuel tank in each hull with deck plate fillers equipped with an overflow prevention device

2 electric fuel gauges (indicator at chart table)

1 fuel pre-filter/water separator + 1 engine fuel filter/engine

Fuel shut-off valves

Fuel Transfer pump

STEERING SYSTEM

2 foam sandwich rudders on stainless steel rudder stock

Hydraulic tiller system with manual pump

2 cylinders (port and starboard)

Aluminium stern tubes

Self lining upper and lower rudderstock bearings

1 emergency tiller

PLUMBING

Prefilter 20 Micron and charcoal for the fill up at shore

Omnipure drink water filter

2 freshwater tanks (900L total capacity) with 1 electric gauge at chart table

2 electric pump and pressure accumulator + one spear

2 60l water heaters

GREY WATER & BLACK WATER

Shower drainage via individual shower pump (automatic pump-out)

Holding tanks for all WCs



BILGE SYSTEM

Bilge pumps directly powered with 12V by the service unit

1 electric automatic bilge pump (4 m³/h) in each engine room

2 electric automatic bilge pump (4m³/h) in each hull

4 automatic starting for bilge pumps with audible and visual alarm at the chart table

1 manual exterior bilge pump

POWER CIRCUIT

Shower power supply 110V with cable

Shower power supply 220V with cable

2 15A/12V engine alternators

1 set of starboard 12V onboard/engine batteries 750A/h (5 x 150 Ah) + 2 optional

1 port engine battery 50A/h/800CCA

1 automatic back-up connection and 1 automatic connection

12V ELECTRICAL DISTRIBUTION

Multiplexed distribution of 24V functions

Chart table function control on navigation screens

Main functions backed up on backup screen

Monitoring: for tanks, batteries, and alarm management

Spare sockets for extra equipment

Размещение:

Berths: 10

Cabins: 5

Head: 5

Crew Berths: 0

Crew Cabins: 0

Maestro 5-cabin version of the Aura 51, featuring a beautifully appointed owner's suite and four double en-suite cabins

Внутреннее оборудование:

Air con individual system in each cabin + 2 in the saloon

Камбуз / Прачечное оборудование:

Galley opened to the outside via a sliding bay

Ventilation via a deck hatch (above the stovetop)

Resin worktop

2 sinks

Hot and cold pressurized water from mixer tap

1 stainless steel 4-burner hob with pan holder

Washing machine 5kg 220V

1 stainless steel gas oven

A central island with 3 storage cupboards, 1 drawer, and 1 rubbish bin accessed vertically, bags evacuated by independent door

Central island that can accommodate a maximum volume of 90L in conservation mode (optional)

3 large storage cupboards under the sink (can accommodate a dishwasher as an option)

1 drawer and 1 storage cupboard beside the oven

1 sideboard behind the hob

Storage on worktop with drawer

At the front, 190L cold storage drawers with 12V cooling system

1 open storage space on the worktop above the cooler

Storage spaces underneath the floor

Lighting via LED spotlights

Multifunction radio switch



Навигационное оборудование:

Saloon GPS plotter & outside GP plotter

GPS Garmin Map 8410 inSar

GPS Garmin 6ps-8610 on fly

CHART TABLE

Raised starboard console for navigation instruments

Storage drawer

1 12V socket

Lighting via LED ceiling spotlight and 1 reading light for the chart table

Multifunction radio switch

VHF 315i

Garmin Ais 800

Autopilot Reactor 40 with screen

Оборудование палубы:

HARDWARE

1 steering compass

3 winch handles with their 2 pockets

Pulpit and pushpit, stanchions with upper and lower guardrails

Pulpits with bow pulpit seats

Access to transom

LOUNGE DECK

Access via staircase from wheelhouse

Area available for sun lounger and mattresses

Visibility 360°

Lounge area with large sofa

COCKPIT

Large cockpit on same level as the saloon

Access via the rear transoms

Transom platform with swimming ladder (starboard) and handrail

1 hot and cold water shower in the starboard and port side

GRP bimini protecting all the cockpit + sun shade

8 seat sofa around the table

1 x 8-place teak cockpit table

Serving hatch to the galley via sliding bay

1 large storage area under the central sit

11 mooring cleats (4 foredeck + 2 middle + 4 astern + 1 in anchor well)

8 fenders

4 x 15 m mooring lines

1 x 1700W electric windlass with circuit breaker protection

Anchor fairlead under bridge deck with built-in bridle

1 roller on forward beam

Net on forward beam

1 starboard-side sofa

1 transom sofa with large storage locker

1 gas chest for 3 bottles + one

1 space for a 90L cockpit refrigerator

Natural lighting and ventilation via 1 deck hatch

Lighting by waterproof LED spotlights

Multifunction radio switch

1 boat wash brush

1 water hose 25mt



FOREDECK SALOON

Large waterproof locker on port side with space for generator

Anchor locker with access by cover

Relaxation area with sun lounger

Рангоут и паруса:

SAILS

Matten CSR mainsail

Genoa furler

Genoa with UV band

RIGGING

Anodised aluminium mast and boom

Full standing rigging

Ball bearing mainsail luff carriages

1 tackle on mainsail halyard

1 topping lift

3 reef lines

1 genoa halyard on mast tensioning rail

1 spinnaker halyard

Lazy-jacks

2 flag halyards

Navigation, running, and mooring LEDs

Deck lighting

HELM STATION

1 mainsheet tackle led aft to coach roof

1 clutch for mainsheet

1 clutch for the mainsail halyard

1 clutch for the spinnaker halyard

1 clutch for the topping line halyard

3 clutches for the reef lines

1 size 55 self tailing winch for mainsail sheet, reef lines

1 size 63 self tailing winch for mainsail halyard

1 size 63 self tailing winch for genoa sheet

1 ball bearing mainsheet traveller

2 tackle on mainsheet traveller clutches with back on roof

genoa tracks with load block

2 genoa sheets

1 halyard storage bag

Аварийно-спасательное оборудование:

epirb

sart

2 horseshoe buoy quick rd 142n orange

2 horseshoe buoy support

2 30m orange floating rope diam 8

1 lifebuoy light m.o.b. (Isa code)

1 rail base for lifebuoy light

4 rubber bucket

1 automatic fog horn

2 aluminium boat hook

12 harness adjust. life link

12 double harness link

2 thermal blanket



1 binocular
1 motoring black cone
1 black anchor ball
1 radar reflector
12 automatic life jackets adult (3 with individual a.i.s balise)+ 2 children's
8 jerry can portable fuel tank 22 litres
2 jerry can portable gasoline tank 22 litres
9 fire extinguisher 1 kg dry powder abc 40 with base
1 shroud cutter
2 safety jacklines lifelink (pair) 10m
2 flare pack: 3 hand signal; 2 smoke signal; 3 parachute signal
1 marine first aid kit dotation 60 m(control every year)
12 thermal protection aid
2 icom m25 waterproof handhed vhf
1 fire blanket
1 set of large softwood plugs
1 set of small softwood plugs
life raft 60 m four water 10 persons (+ bag for oceanic croissing)

Комментарии брокера:

Aura 51, build by Fountaine Pajot, is a Maestro 5-Double Cabin Catamaran that combines contemporary elegance with effortless functionality. Designed for indoor-outdoor living, the catamaran features a fluid connection between the cockpit and saloon, enhanced by a galley-up layout that creates an open, welcoming atmosphere.

A striking teak dining table anchors the social area, comfortably accommodating up to eight guests. Easy and intuitive to sail, Aura 51 offers a spacious, well-shaded flybridge with all sail controls led efficiently to the helm, flush decks for a sleek profile. Inside, the saloon provides a refined retreat with deep, plush sofas. She includes a luxurious owner's suite and four double en-suite cabins.

Местонахождение:

Caribbean





Схема яхты

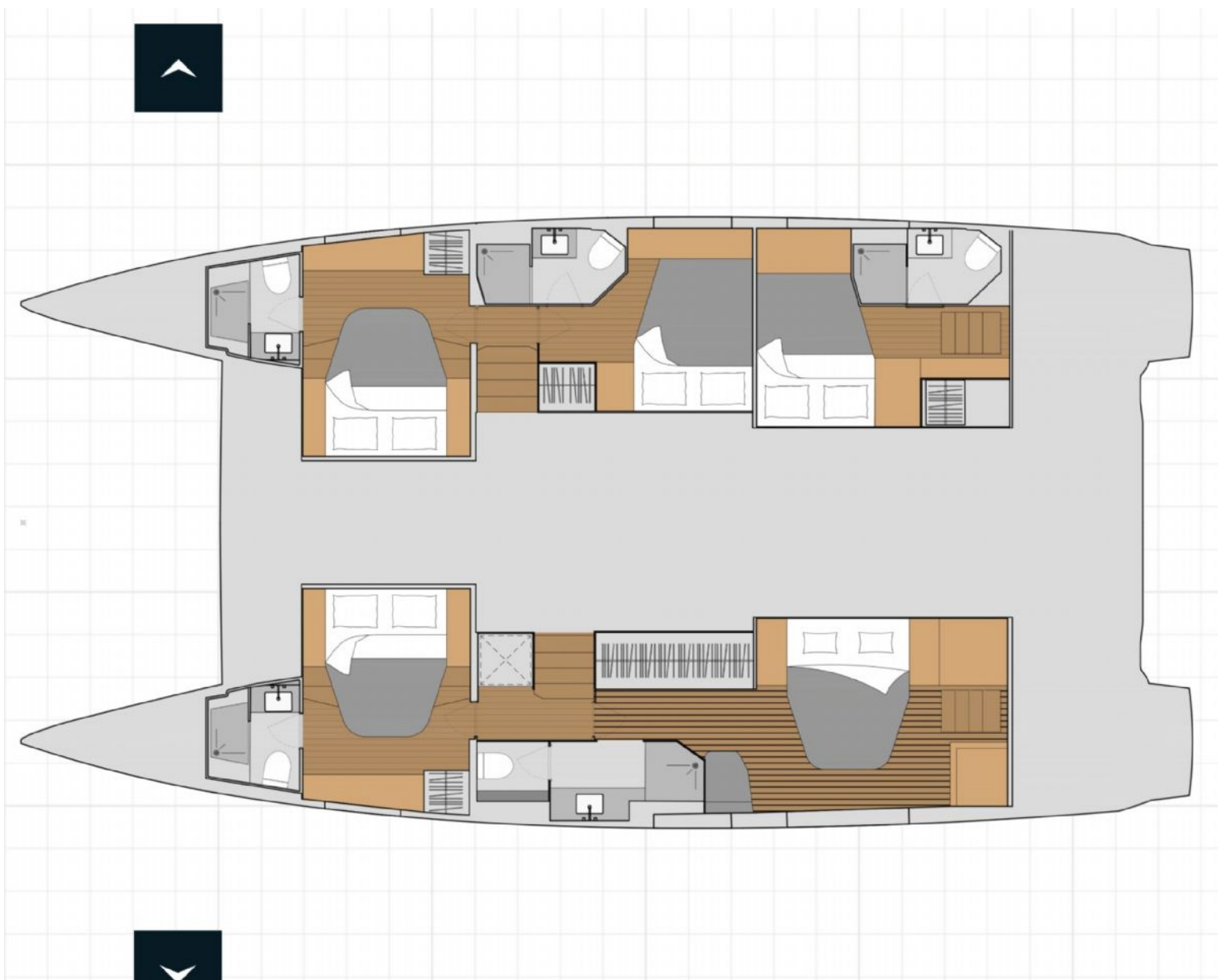

Все представленные выше данные основаны на информации, предоставленной продавцами. Данная информация считается достоверной, однако мы не несем ответственности за ее точность. Потенциальному покупателю настоятельно рекомендуется самостоятельно проверить предоставленную информацию и воспользоваться услугами квалифицированного морского эксперта и / или произвести проверку двигателей. В том случае, если проверка двигателей будет произведена нашей компанией, это не влечет никакой ответственности с нашей стороны.